

# evolution®

evolutionpowertools.com

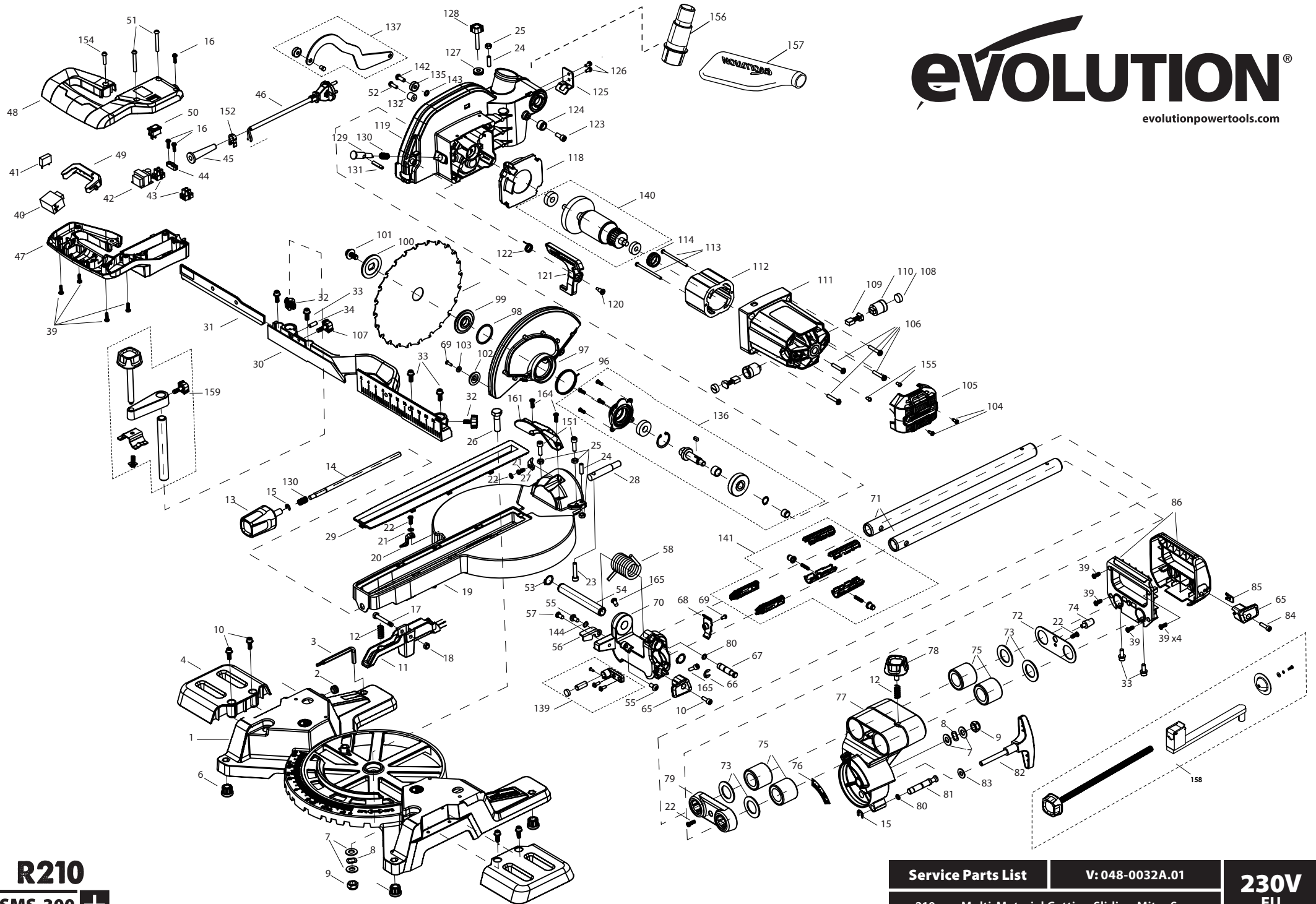

**R210**

**SMS-300 +**

**Service Parts List**

**V: 048-0032A.01**

**210mm Multi-Material Cutting Sliding Mitre Saw**

**230V  
EU**

No.	Description	Part Code	Qty	No.	Description	Part Code	Qty	No.	Description	Part Code	Qty
1	Base (SMS-300) (BLK)	048-0300	1	75	Linear Ball Bearing	048-0162	4	159	"Top Clamp Assembly SMS-300 (Plus Version)"	048-0330	1
2	Grommet 10mm	048-0101	1	76	Bevel Label	048-0163	1	161	Chip Guard (SMS-300)	048-0309	1
3	Dual Hex Key	048-0102	1	77	Bevel bracket	048-0164	1	164	Cross Head Screw M5x14	F-SPHPZ-M5-14-ST-BO	2
4	Table Extension (SMS-300)	048-0301	2	78	Sliding Lock Screw (R210)	048-0165	1	165	Cap Screw M5x10	F-SHCS-M5-10-ST-BO	2
6	Foot	048-0105	4	79	Rail Spacer Cover	048-0311	1				
7	Flat Washer 10mm	F-W-M10-ST-BO	4	80	O-Ring	048-0167	2				
8	Wave Washer 12mm	048-0113	2	81	33.9 Pin	048-0168	1				
9	Nylock Nut M10	F-NNIF-M10-ST-BO	2	82	Bevel Lock lever (R210)	048-0169	1				
10	Cap Screw M5x20	F-SHCS-M5-20-ST-BO	5	83	Flat Washer 8mm	048-0171	1				
11	Table Positioning Handle (SMS-300)	048-0302	1	84	Cap Tapping Screw 5x20	F-TFPX-5-20-ST-BO	1				
12	Spring	048-0108	1	85	Cable Strain	048-0172	1				
13	Table locking knob (R210)	048-0109	1	86	Rear Handle (Plus Unit)	048-0265	1				
14	Push Rod (SMS-300)	048-0303	1	96	Blade Guard Torsion Spring	048-0183	1				
15	External E-clip 6mm	048-0112	2	97	Blade Guard (BLK)	048-0266	1				
16	Tapping Screw 4X16	F-TFPX-4-16-ST-BO	3	98	Blade guard Retaining ring	048-0185	1				
17	Screw M6x43	F-HB-M6-43-8-ST-BO	1	99	Inner flange	048-0186	1				
18	Nylock Nut M6	F-NNIF-M6-ST-BO	1	100	Outer flange	048-0187	1				
19	Table (SMS-300)	048-0304	1	101	Arbour Bolt M8x16	048-0188	1				
20	Table Indicator (R210)	048-0115	1	102	Guard Roller	048-0189	1				
21	Flat Washer 5mm	F-W-M5-ST-BO	2	103	Washer	F-W-M4-ST-BO	1				
22	Cross Head Screw M5X12	F-SPHPZ-M5-12-ST-BO	4	104	Tapping Screw 4X10	F-TFPX-4-10-ST-BO	2				
23	Cap Screw M6x30	F-SHCS-M6-30-ST-BO	3	105	Motor End Cap (R210)	048-0192	1				
24	Grub Screw M6X20	F-SSCCP-M6-20-ST-BO	2	106	Cross Head Screw M5X30	F-SPHPZ-M5-30-ST-BO	4				
25	Hex Nut M6	F-NSF-M6-ST-BO	4	107	Wing screw (R210) 18mm	048-0315	1				
26	Hex Head Bolt M10x45	F-HB-M10-45-25-ST-BO	1	108	Brush Holder Cap	048-0194	2				
27	Neck indicator (R210)	048-0117	1	109	Carbon Brush 230V (Pair)	048-0195	2				
28	Connecting Bolt	048-0119	1	110	Brush Holder	048-0196	2				
29	Channel Guide (SMS-300)	048-0305	1	111	Motor Housing	048-0197	1				
30	Fence (SMS-300)	048-0306	1	112	Field Coil 230V	048-0198	1				
31	Movable fence (SMS-300)	048-0307	1	113	Tapping Screw M4x68	F-TFPX-M4-65-ST-BO	2				
32	Wing screw (R210) 13mm	048-0124	2	114	Bearing Cap	048-0202	1				
33	Fence Bolts (custom hex bolts M6)	048-0248	5	118	Air Baffle	048-0207	1				
34	Grub Screw M6X16	F-SSCCP-M6-16-ST-BO	1	119	Head	048-0208	1				
39	Tapping Screw 4X14	F-TFPX-4-14-ST-BO	9	120	Cross Head Shoulder Screw M4X6.7	048-0209	1				
40	On/Off Switch	048-0131	1	121	Guard lock lever (R210)	048-0210	1				
41	Capacitor (230v)	048-0132	1	122	Torsion Spring	048-0212	1				
42	Laser Transformer (230V)	048-0136	1	123	Cap Screw M6x16	F-SHCS-M6-16-ST-BO	1				
43	Connection Block	048-0140	2	124	Head Stop	048-0213	1				
44	Cable Clamp	048-0141	1	125	Finger Guard	048-0214	1				
45	Cable Sheath	048-0142	1	126	Cross Head Screw / Washer M4X10	048-0190	2				
46	Power Cable 230V EU (3m PVC)	048-0272	1	127	Trench Cut Adjustment	048-0215	1				
47	Lower Handle	048-0143	1	128	Trench cut Knob (R210)	048-0216	1				
48	Upper Handle	048-0144	1	129	Spindle lock	048-0218	1				
49	Trigger (R210)	048-0145	1	130	Compression Spring	048-0219	2				
50	Laser Switch	048-0147	1	131	Roll Pin 5mm	048-0220	1				
51	Cross Head Screw M5X40	F-SPHPZ-M5-40-ST-BO	2	132	Guard Stop	048-0223	1				
52	Cross Head Screw M5X16	F-SPHPZ-M5-16-ST-BO	2	135	Bearing 6x17x6	F-B-606-2Z	1				
53	External Circlip 16mm	F-CCEXT-16-100-ST-PO	2	136	Gearbox Assembly	048-0229	1				
54	head Pivot Axle	048-0148	1	137	Linkage Assembly	048-0230	1				
55	Cross Head Shoulder Screw M6x9	048-0149	2	139	Laser Assembly	048-0233	1				
56	Trench stop	048-0150	1	140	Armature Assembly 230V UK/EU	048-0234	1				
57	Cross Head Shoulder Screw M6x9	048-0151	1	141	Slide Shaft Locking unit	048-0238	1				
58	Torsion Spring	048-0152	1	142	Cross Head Screw M6X16	F-SPHPZ-M6-16-ST-BO	1				
65	Cable tidy (R210)	048-0154	2	143	Flat Washer 4mm	F-W-M4-ST-BO	1				
66	External E-clip 8mm	048-0156	1	144	Wave Washer 7mm	048-0239	1				
67	Lockdown Pin Knob	048-0157	1	151	Cap screw M6x20	F-SHCS-M6-20-ST-BO	2				
68	Laser Wire Cover	048-0158	1	152	Cord Clip 230V	048-0247	1				
69	Cross Head Screw M4x8	F-SPHPZ-M4-8-ST-BO	2	153	Label Set 230V UK	S300 label set	1				
70	Head Pivot	048-0159	1	154	Cross Head Screw M5X20	F-SPHPZ-M5-20-ST-BO	1				
71	Rail (SMS-300)	048-0308	2	155	Cross Head Screw M4x8	F-SPHPZ-M4-10-ST-BO	2				
72	Bevel bracket Cover	048-0161	1	156	Dust Port Adaptor	027-0220	1				
73	Shaft Seal Ring	030-0192	4	157	Dust Bag	048-0259	1				
74	Rubber Stop	030-0152	2	158	Front Clamp Assembly (Orange) 300mm	048-0320	1				



<b>Service Parts List</b>	<b>V: 048-0032A.01</b>	<b>230V</b> EU
<b>210mm Multi-Material Cutting Sliding Mitre Saw</b>		