

# evOLUTION<sup>®</sup> PANEL CARRIER

## How to use:

1. Place the panel carrier securely on the top edge of the material in the centre of the board to effect proper grip and balance.
2. Ensure that both rubber pads are in full pressure contact with the material before lifting. Failure to do so could result in the material being inadequately gripped and potentially slip. Use only with materials that are level, smooth, clean and free from obstructions.
3. The tension on the two gripping plates are adjustable by tightening or loosening the lock nuts on sides of the arms. It might be necessary to increase the tension after long-term use. Do not loosen the tension too much to avoid accidental release of the board.

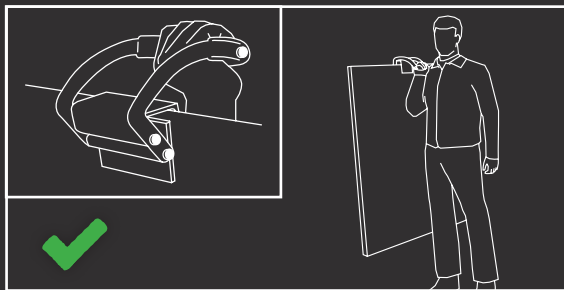
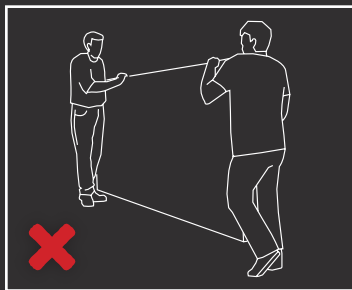

**Ideal for moving large sheet material when working with**



Circular Saws



Table Saws



Paddle Mixers