



Peter Mitchell

Hull

Evolution Rating: ★★★★★

Difficulty: **Intermediate**

Duration: **1 Day**

Garden Arm Chairs

Pete shows his DIY skills by producing some amazing garden arm chairs, including an Adirondack chair using his Evolution power tools, which will go to charity. Easy to build, just need a comfy pillow to finish it off.



Materials & Tools

- Evolution RAGE3-S Sliding Mitre Saw
- Evolution RAGE5 Table Saw
- 2" Screws
- 2-1/2" Screws
- Wood Glue
- Paintable Silicone or wood filler
- Finishing Supplies

See a full list of cuts need on the next page.



I searched the internet for ideas on which chair to build. I came across an Adirondack whilst watching some YouTube videos and got some free plans, which came with the video from Steve Ramsey at Woodworking For Mere Mortals.

I was looking for appropriate materials for the project and luckily a neighbour was renewing their fence and kindly donated the old fence, which I then stripped down to the planks. The wood came out at 6' x 6" x 1" (1829mm x 153mm x 25mm).

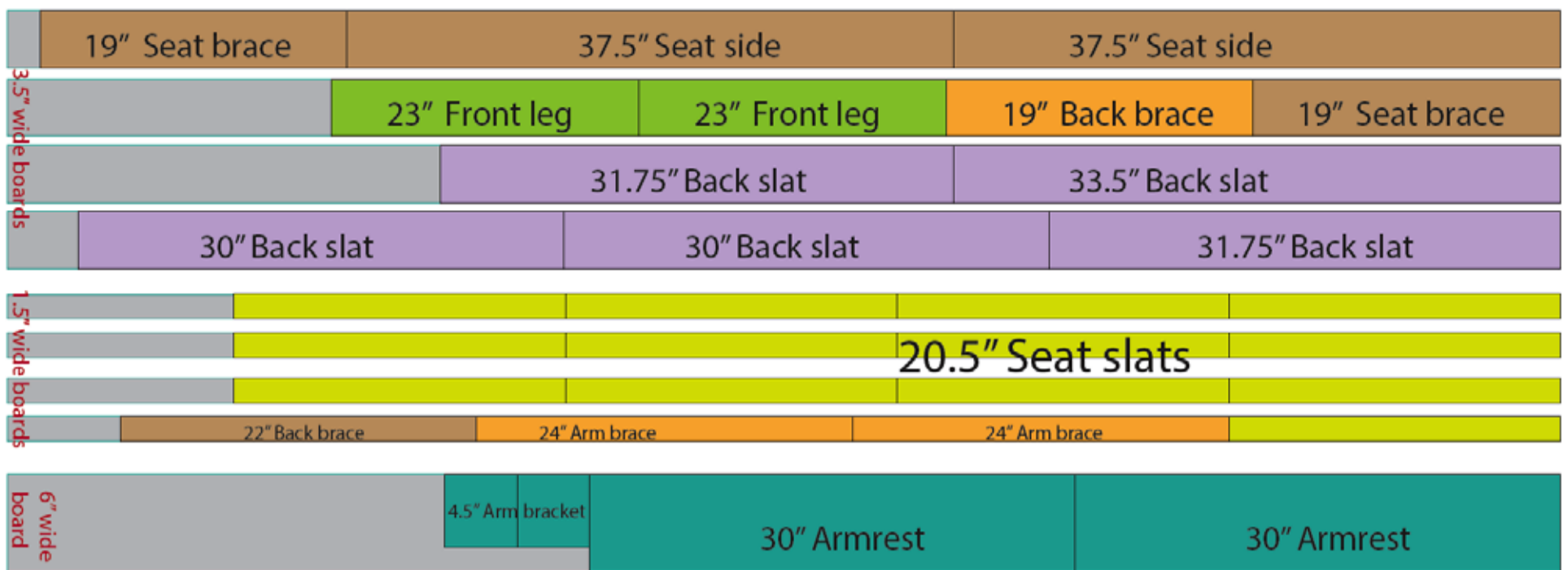

Step 1

Using the measurements provided, cut the wood down to length using the Evolution RAGE3-S sliding mitre saw, and then cut down to width on the Evolution RAGE5 table saw. Then using the Evolution mini belt sander to sand the old stain and the roughness off the wood.



Step 2

I rounded off the selected pieces of wood that needed a round end using an Evolution RAGE7-S Jigsaw and sanded off the rough edges.



Step 3

I then rounded over the seat slats on my router.

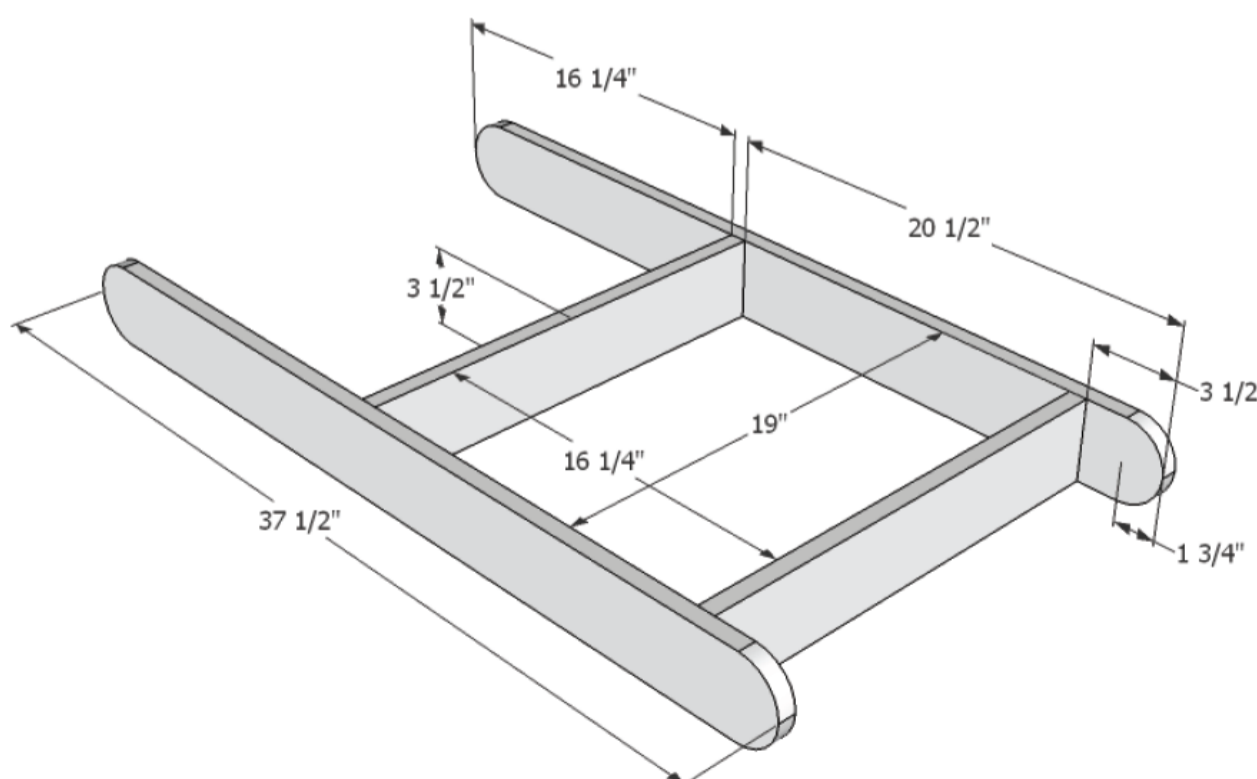

Next follow the diagrams as follows.

Step 4

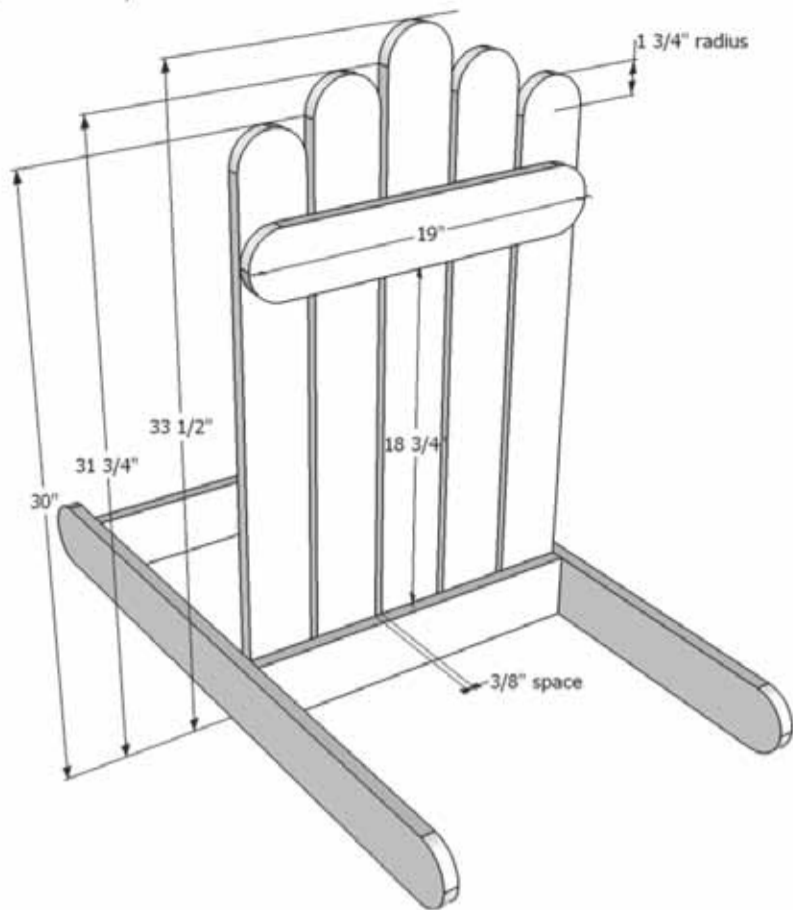

Step 5

Back Slats. (Reverse view)

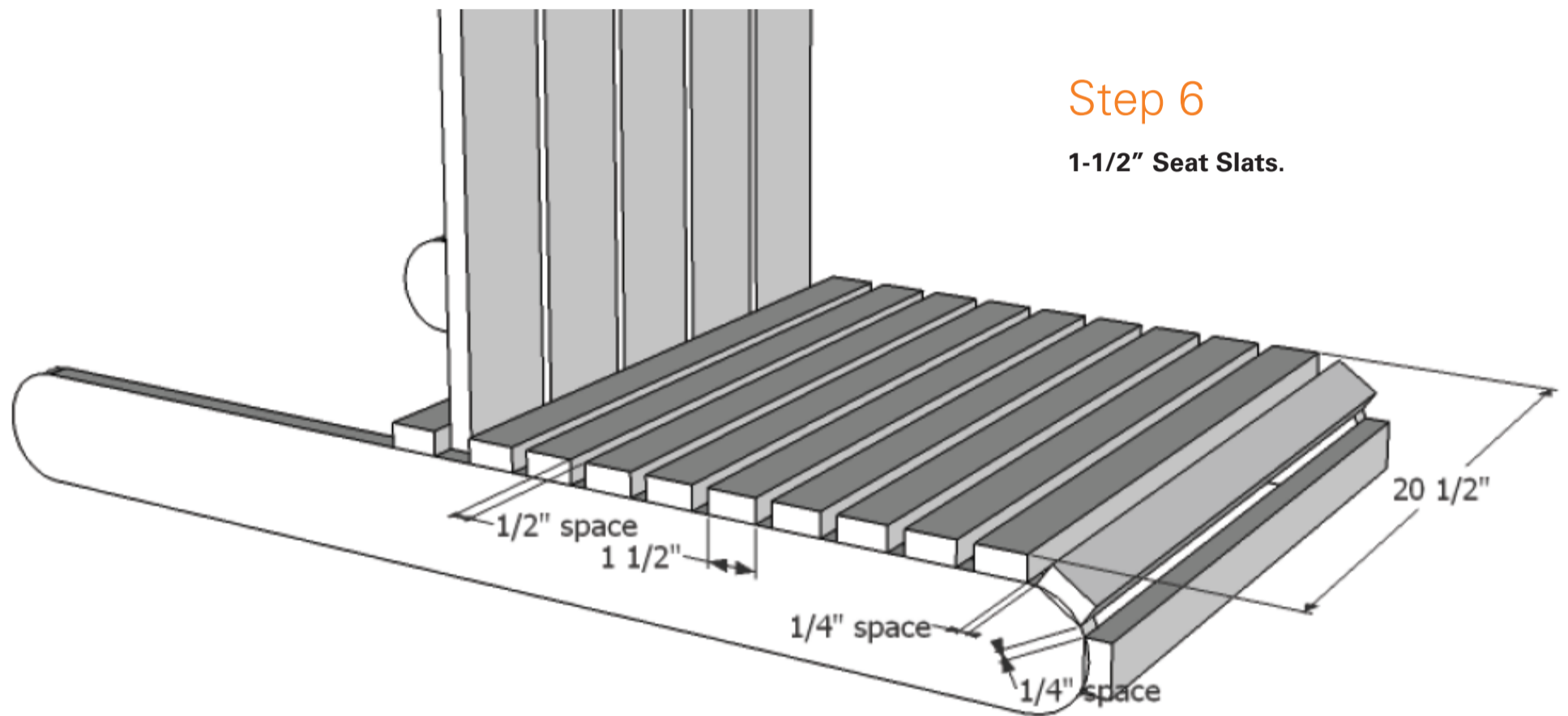

Step 6

1-1/2\"/>



Step 7

I used some scrap piece of wood and drilled some plugs to fill the counter sunk holes and glued and hammered them into place and trimmed off the excess after an hour of drying and sanded them flush with the other wood.

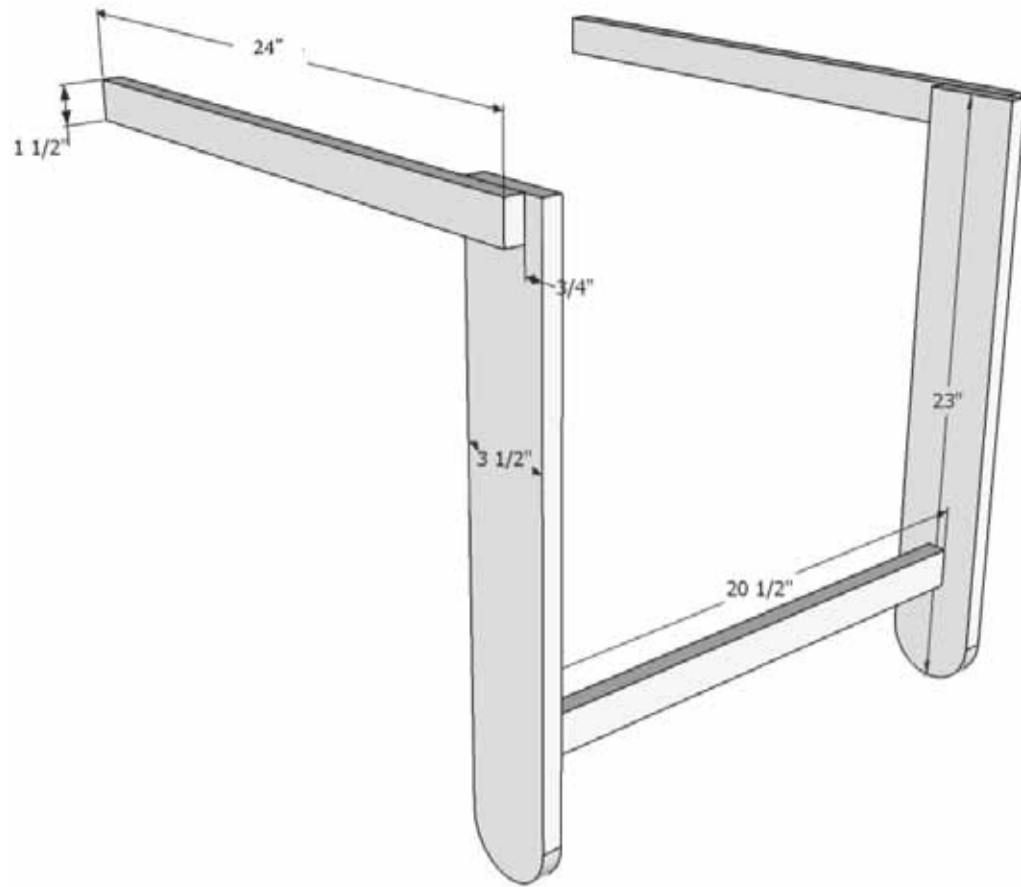

Step 8

Arm Braces & Front Legs

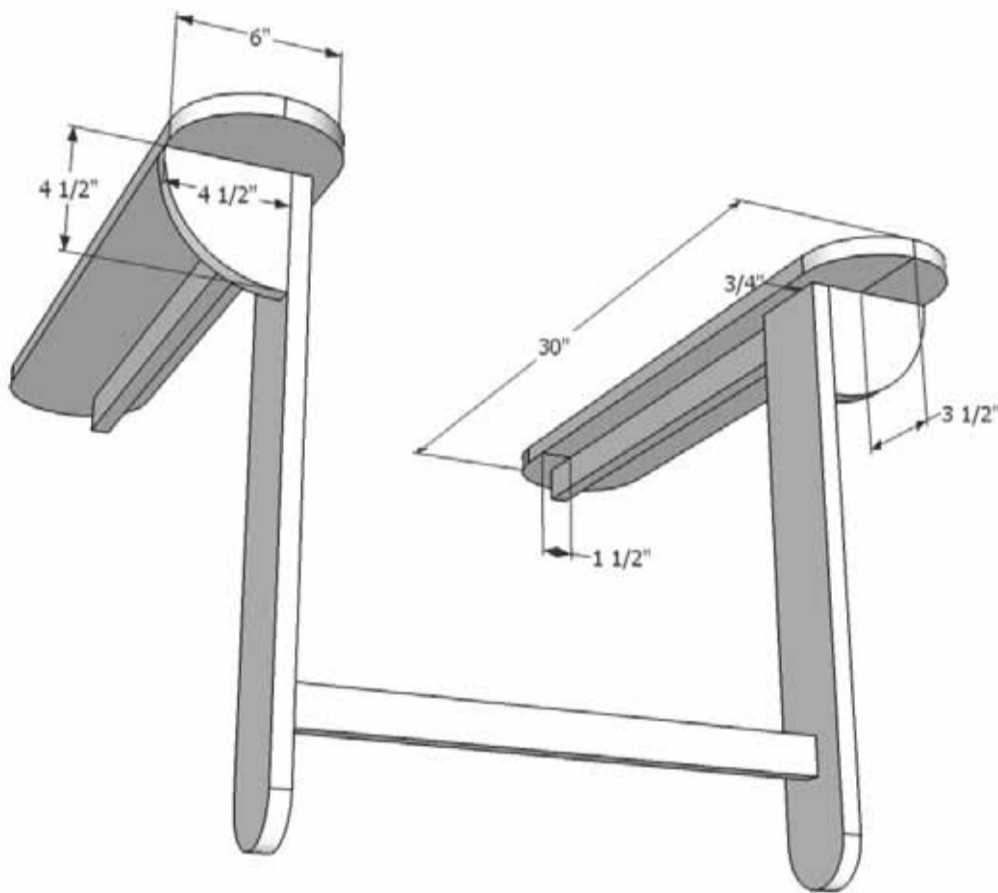

Step 9

Arms & Brackets

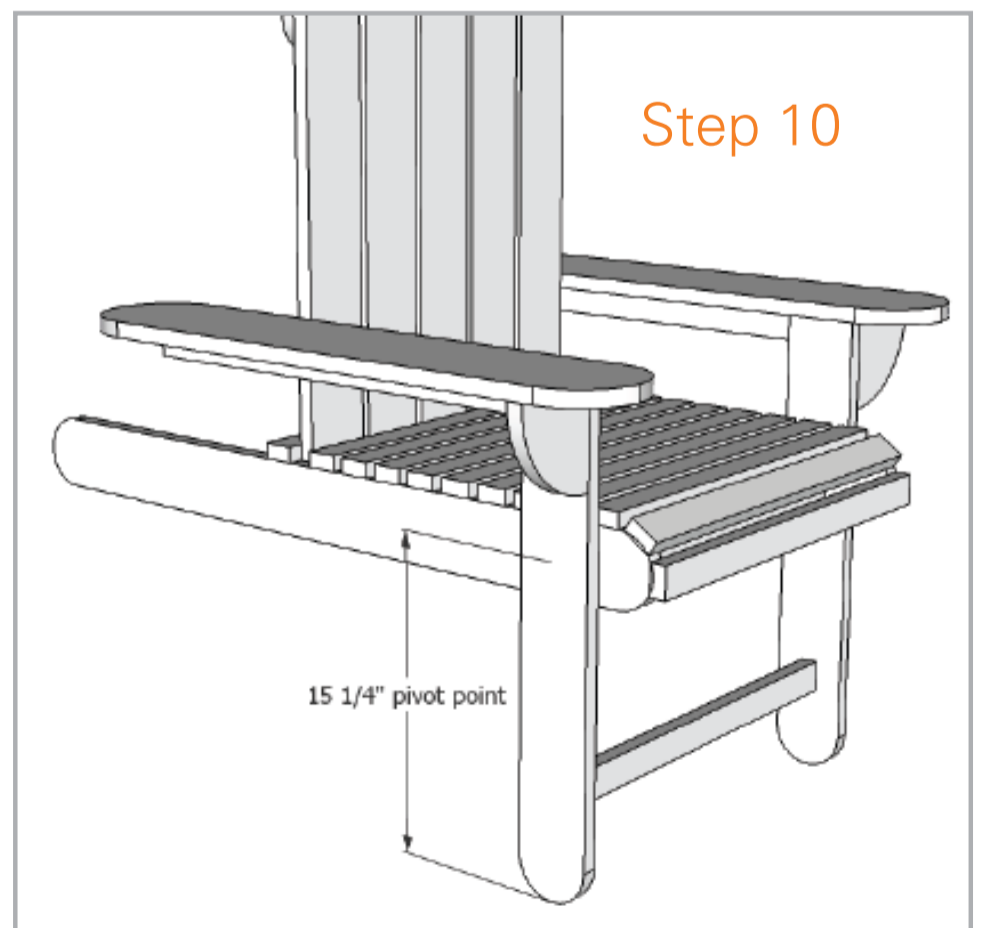
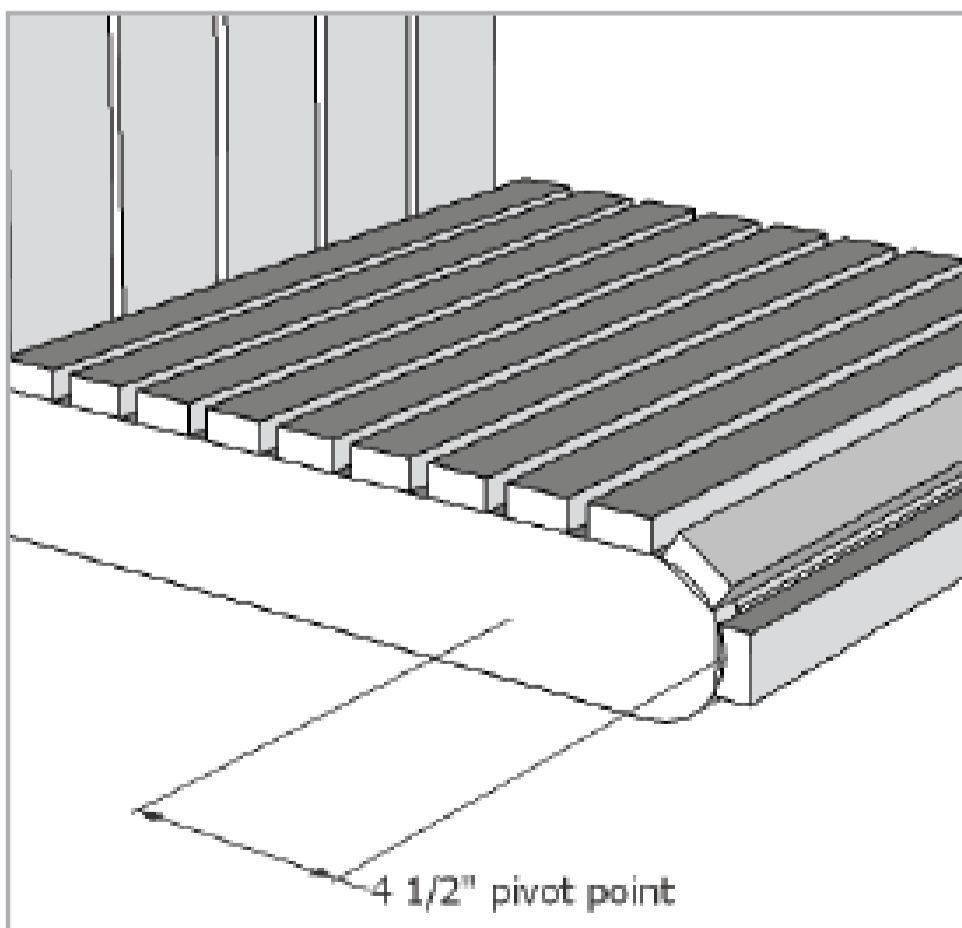

Step 10

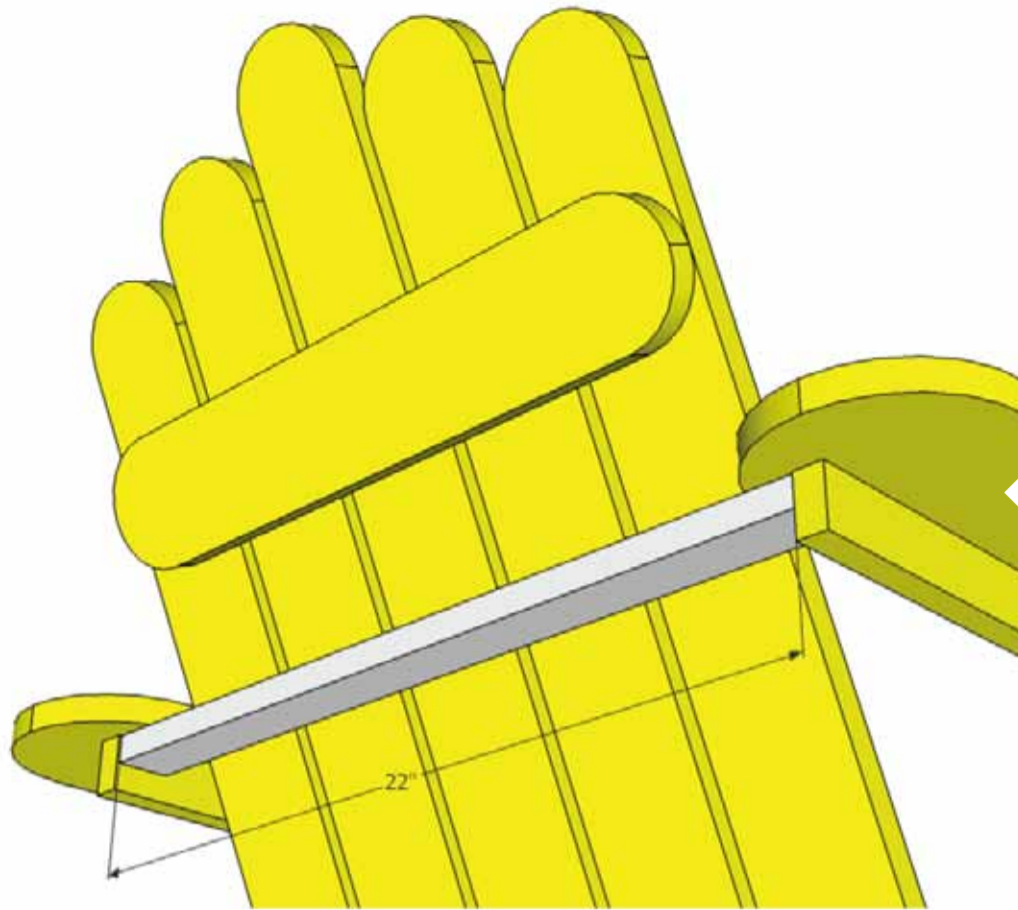

Step 11

Attach Back Brace



Step 12

I then assembled the front legs and the arm rest pieces and filled in some of the holes with wood filler and gave the whole chair a good sanding and wiped it down with a damp cloth to get rid of the dust left on it.



Step 13

Finally I had to source some wood stain from my local hardware shop, I chose a deep mahogany finish and used my air compressor spray gun to apply, but a brush could also be used here.

Featured Evolution Power Tools



RAGE3-S

210mm Multipurpose
Sliding Mitre Saw



RAGE5

255mm Multipurpose
Table Saw



MINI SANDER

280W Multipurpose
Mini Belt Sander



RAGE7-S

710W Multipurpose
Corded Jigsaw

YOUR CUT ABOVE CUT ABOVE AWARDS 2014

PRESENTED BY **EVOLUTION**

Submit Your Latest Project!

Fantastic Prizes For Entrants...

- 1 FREE TCT Multipurpose Blade!**
For every project published.
*Chosen by Evolution's judging panel.
Projects to publish on cutaboveawards.com
- 2 FREE Evolution Power Tool!**
For the project of the month.
*Chosen by Evolution's judging panel.
- 3 £1000 worth of Evolution Tools!**
For the project with the most 'Likes'.
*Chosen by Evolution's judging panel on the
1st December 2014.

