

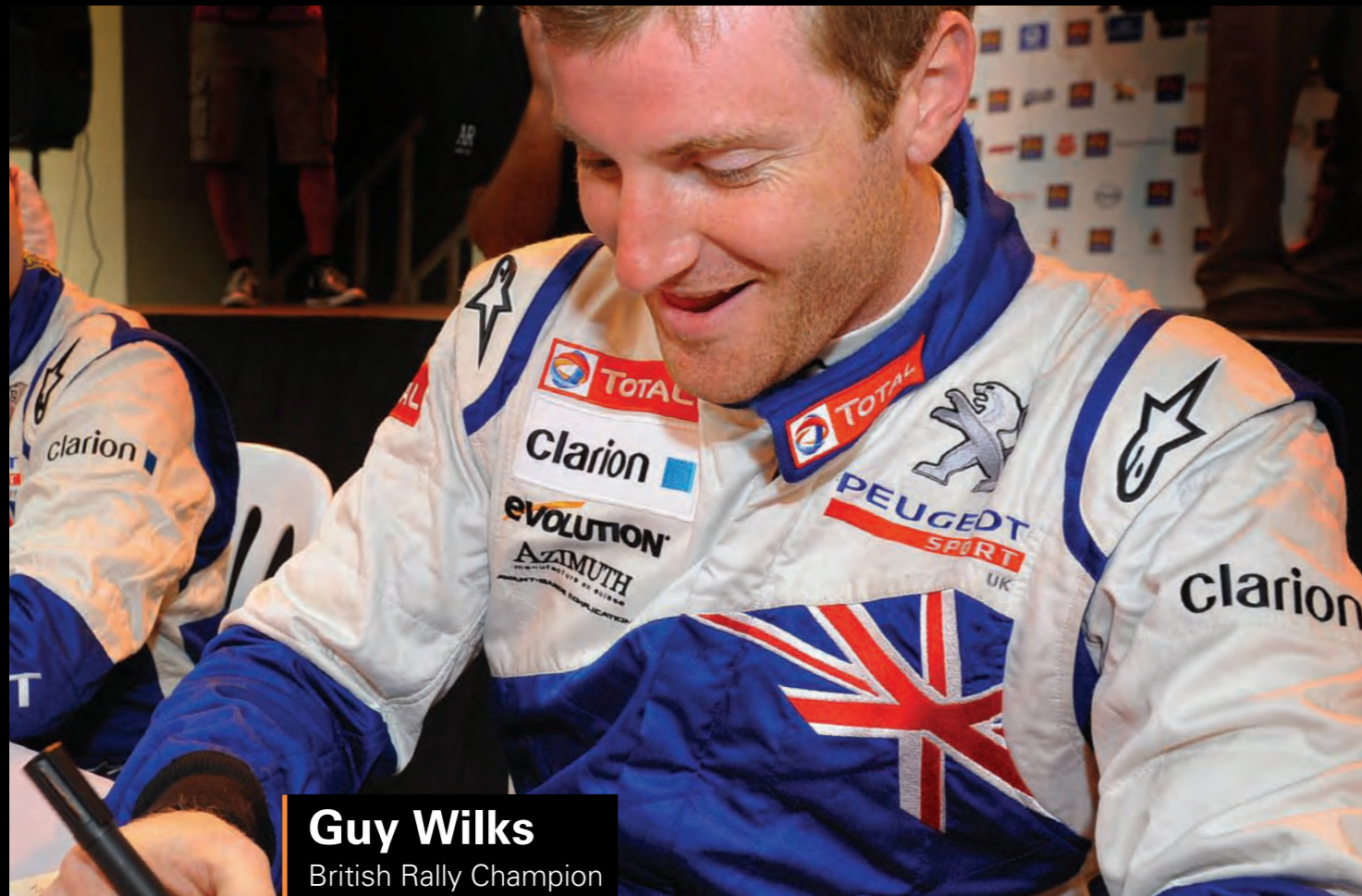

EVERY  
RANGE.  
EVERY  
WHERE.  
EVERY  
WAY.



**Guy Wilks**  
British Rally Champion



**Sheffield United FC**



**Power Boat Racing**



**Shaun Murphy**  
World Snooker Champion

After 20 years in the industrial power tool market Evolution has established a well earned reputation and are recognised worldwide as a market leader within the Steel & fabrication industry.

**ADVANCED TCT TECHNOLOGY**

Evolution has traditionally specialised in Steel dry cutting technology and has pioneered advanced TCT saws which cut Steel. Utilising this knowledge and experience, Evolution have developed this technology into a range of multipurpose saws which cut Steel, Aluminium & Wood, all with one saw and one blade.

04

**evolutionPROJECT®**

DIY range with professional features, at affordable prices.

08

**evoSYSTEM®**

One engine, multiple outputs, endless functionality.

10

**evolutionBUILD®**

Professional power tools suitable for the construction site.

17

**evolutionSTEEL®**

Heavy-duty industrial Steel working power tools & accessories.

16

**STEALTH™**

Exclusive promotional concepts designed to sell.

20

**PURE**

Cordless OPP products great for superstores.

22

**YOUR BRAND.  
OUR EXPERTISE.**

Introducing our new innovative saws, designed to revitalise your range and rocket your sales!

IT TOOK ME LESS THAN

**2 HOURS**  
TO CUT ALL MY WOOD -  
THAT'S ALMOST  
**2 HUNDRED CUTS!**

I WAS TOTALLY WON OVER BY THE FURY MULTIPURPOSE SAW -  
**SMOOTH, ACCURATE & A FANTASTIC  
SPLINTER-FREE FINISH.**

I ORIGINALLY ESTIMATED IT WOULD  
TAKE 2 OR 3 WEEKENDS TO REPLACE  
ALL 18 PANELS, BUT I DID IT ALL IN ONE!

**KEEN DIY'ER - STEVE JENKINS**

**DIY**

**Multipurpose Power Tools  
and Accessories**

Offering innovation and versatility  
for the DIY enthusiast. These are  
high performance power tools  
capable of cutting through a wide  
range of applications.



# THE ULTIMATE CUTTING TOOL FOR ANY HOME WORKSHOP

CUT STEEL, ALUMINIUM & WOOD WITH NAILS

## FURY

185mm TCT Multipurpose Circular Saw



# THE WORLD'S FIRST MULTIPURPOSE TABLE SAW

CUT STEEL, ALUMINIUM & WOOD WITH NAILS

## FURY5

255mm TCT Multipurpose Table Saw



### Cut

- Steel
- Aluminium
- Plastics
- Wood with Nails
- Hardwood
- Softwood
- Rebar
- Copper
- Composite Woods
- Decking
- Laminate Flooring
- PVC
- Plexiglass
- Plywood
- Steel Grate
- Rubber Hose
- Conduit
- Unistrut
- MDF
- Cable Tray
- Diamond Plate
- Steel Studs
- Angle Iron
- Corrugated Metal
- Fence Posts
- Framing
- Vinyl Siding
- Flashing
- Window Fittings & Much More!

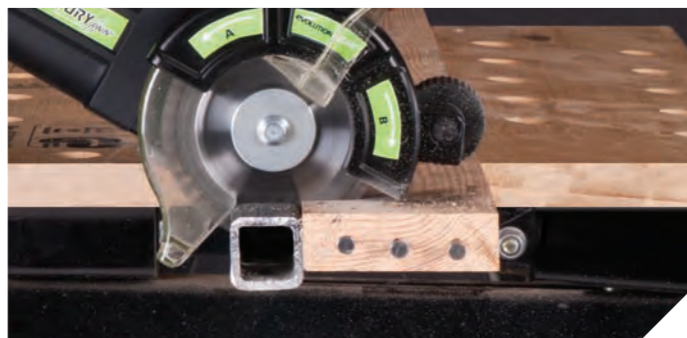

### FURY TWIN 90

90mm Multipurpose Twin Blade Cutter



### FURY TWIN 125

125mm Multipurpose Twin Blade Cutter



### BLADES

FURY Multipurpose Blades and Diamond Blades

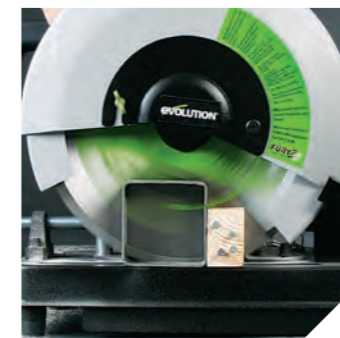

### FURY2

355mm TCT Multipurpose Cut Off Saw



### FURY3-B

210mm TCT Multipurpose Compound Mitre Saw

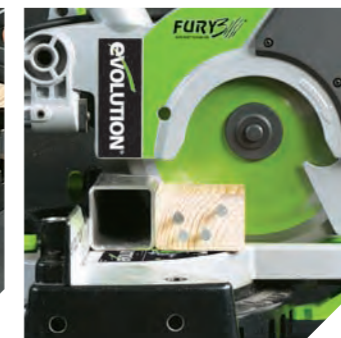

### FURY3

210mm TCT Multipurpose Sliding Mitre Saw



### FURY3-XL

255mm TCT Multipurpose Sliding Mitre Saw



### FURY5

255mm TCT Multipurpose Table Saw

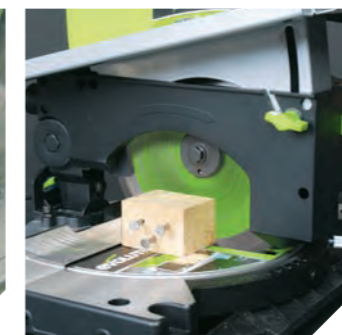

### FURY6

210mm TCT Multipurpose Mitre / Table Saw



### VSM480

1100W Variable Speed Mixer



### SDS4

Four Function SDS Drill

# ONE ENGINE. MULTIPLE OUTPUTS.

## REVOLUTIONISING OUTDOOR POWER EQUIPMENT.

One engine unit powers a range of compatible outputs providing incredible versatility, flexibility and saving you money!

Because you only need one engine you can cut your costs considerably by investing into the Evo-System® range.

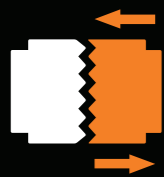

Quick release coupling allows easy output connectivity with no tools required.



LINE-UP



LOCK-IN



### ENGINE UPGRADES



**MITSUBISHI**  
Power: 6HP  
CC: 181  
Fuel Capacity: 3.8L



**YAMAHA**  
Power: 5.5HP  
CC: 171  
Fuel Capacity: 4.5L



**HONDA**  
Power: 5.5HP  
CC: 196  
Fuel Capacity: 3.1L

### EVOLUTION ENGINE

- ✓ Wheel kit provides mobility.
- ✓ Folding handle for storage.
- ✓ Robust & durable Steel frame.
- ✓ Quick release coupling.

- Power: 6.5HP, 4-Stroke
- Power Take Off (PTO)
- Easy Recoil Start
- Fuel Capacity: 3.1L

### GENERATOR

- ✓ Switchable voltages.
- ✓ Thermal cut-outs.
- ✓ Automatic voltage regulation.
- ✓ Sturdy Steel frame.

- Power: 2400W (Continuous)
- AC Output
- Sockets: 1 x 110V & 1 x 230V

### PRESSURE WASHER

- ✓ High quality brass pump.
- ✓ Includes lance with adjustable nozzle & hose.
- ✓ Built-in detergent system.

- Max. Flow Rate: 8L/min
- Rated Pressure: 175bar
- Max. Pressure: 220bar

### WATER PUMP

- ✓ Pumps 1000L per minute.
- ✓ Inlet filter prevents unwanted debris from entering the pump.
- ✓ Sturdy Steel frame.

- Use With: 3" (75mm) Hose
- Suction Height: 8m
- Pump Lift: 28m

Ask our team about future outputs for the Evo-System®



GENERATOR



PRESSURE WASHER



WATER PUMP



Watch the video on your smart phone now!

I CAN'T THINK OF ANY  
**MANUFACTURER**  
OUT THERE THAT HAS A PRODUCT OF THIS  
**CALIBRE!**  
NOTHING ELSE COMPARES  
TO THE RAGE3.

CONSTRUCTION PRO - TERRY BURGESS



## PRO

Multipurpose Power Tools  
and Accessories

For the construction industry and subsidiaries. Offering an innovative multipurpose TCT saw range suitable for daily use, which cuts Steel, Aluminium & Wood with one saw and one blade.





**RAGE TWIN 125**

125mm TCT  
Multipurpose Twin Blade Saw



**RAGE TWIN 155**

155mm TCT  
Multipurpose Twin Blade Saw



**RAGE-B**

185mm TCT  
Multipurpose Circular Saw



**RAGE**

185mm TCT  
Multipurpose Circular Saw



**RAGE230**

230mm TCT  
Multipurpose Circular Saw



**RAGE2**

355mm TCT  
Multipurpose Cut Off Saw



**RAGE4**

185mm TCT  
Multipurpose Cut Off Saw



**RAGE5**

255mm TCT  
Multipurpose Table Saw



**RAGE6**

255mm TCT  
Multipurpose Mitre / Table Saw



**RAGE7**

18V Li-Ion  
Multipurpose Jigsaw



**MITRE SAW STAND**

With Extendable Arms



**BLADES**

RAGE Multipurpose Blades  
and Diamond Blades



**HULK**

400 x 320mm Petrol  
Compaction Plate



**HULK ELECTRO**

400 x 320mm Electric  
Compaction Plate



**DISC CUTTER**

305mm Electric  
Disc Cutter



**MINI BELT**

280W Multipurpose  
Mini Belt Sander



**PRECISION FILE**

400W Multipurpose  
File Sander



**HDG200**

2000W Heat Gun  
Variable Heat Control



**SDS4-800**

Four Function  
SDS Drill



**DRY WALL SANDER**

600W 225mm Disc  
With Telescopic Arm



**TWISTER**

Professional Variable  
Speed Mixer



**BORA**

1200W 28mm  
Magnetic Drilling System



**DIE GRINDER**

500W Industrial Die Grinder  
PLUS 20pc Accessory Kit

**RAGE3-S**  
210mm Sliding  
Mitre Saw



# CUT STEEL, ALUMINIUM AND WOOD, USING JUST ONE BLADE!

TRANSFORMS INTO THE  
PERFECT TILE CUTTER WITH  
THE DIAMOND BLADE FITTED



**RAGE3-B**  
210mm Compound  
Mitre Saw



**RAGE3-S300**  
210mm Sliding Mitre Saw  
With 300mm Slide



**RAGE3**  
255mm Sliding  
Mitre Saw



**RAGE3-DB**  
255mm Double Bevel  
Sliding Mitre Saw

# TRULY MULTIPURPOSE MITRE SAWS...

## Cut

- Steel
- Aluminium
- Plastics
- Wood with Nails
- Hardwood
- Softwood
- Rebar
- Copper
- Composite Woods
- Decking
- Laminate Flooring
- PVC
- Plexiglass
- Plywood
- Steel Grate
- Rubber Hose
- Conduit
- Unistrut
- MDF
- Cable Tray
- I-Beams
- Diamond Plate
- Steel Studs
- Angle Iron
- Corrugated Metal
- Fence Posts
- Framing
- Vinyl Siding
- Flashing
- Window Fittings  
& Much More!

# NEW PACKAGING



# NOW LAUNCHED!

## OUR PACKAGING SPEAKS MANY LANGUAGES...

- Impactful and professional brand, from a name people trust.
- Universally understood specification symbols.
- Large imagery displays USP - Cut Steel, Aluminium & Wood, all with one blade!
- QR (Quick Response) technology links to demonstration videos via a smart phone.
- Strong, corporate packaging design throughout the Evolution range.
- Multi-lingual instruction manual, **using the latest 3D Via CAD illustrations** →

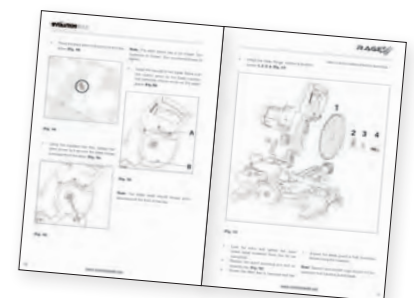



# SPECIAL EDITION MITRE SAWS

Evolution's **promotional concepts** have transformed into a huge success, for the world's top retailers! Offering end-users **incredible price points** with **mass appeal**, our concept of **Special Edition's** keeps on growing - which one will you choose?

AVAILABLE IN 210mm & 255mm MITRE SAWS - POPULAR EDITIONS INCLUDE...



Camouflage



Platinum



Gloss Red



Eco-Friendly



Rally



Union Jack

WORKING ON AN INDUSTRIAL SITE,  
I ASKED THE SCAFFOLDER  
FOR AN OFF-CUT OF  
SCAFFOLDING PIPE,

I STARTED THE SAW  
& CUT THE  
PIPE IN HALF!

LIKE A KNIFE  
THROUGH  
BUTTER!

INDUSTRIAL STEEL WORKER - PHIL DICKENS

# STEEL WORKING

## Heavy-Duty Industrial Power Tools and Accessories

A range of specialist products dedicated to the Steel industry. Pioneering dry cutting technology, these are heavy duty industrial tools suitable for sustained daily use.

EVOLUTION®  
EV0355



READY TO  
HANDLE EVEN  
THE MOST  
DEMANDING  
ON-SITE JOBS



**EV0180**  
180mm Circular Saw



**EV0230**  
230mm Circular Saw



**EV0355**  
355mm Chop Saw



**BLADES**  
Steel, Thin Steel, Stainless Steel,  
Aluminium & Wood Blades



**EV042**  
42mm Magnetic Drill



**ANNULAR CUTTERS**  
Great Value Cutter Sets



**SWARF COLLECTOR**  
Cyclone Magnetic Stick

# PURE



## DIY MADE SIMPLE

ONE BATTERY POWERS THE RANGE

Pure is an exciting range of eco-friendly power tools, designed and manufactured to set standards in the following areas:

- Use materials from recycled and sustainable sources.
- Use biodegradable, optimum sized packaging and water based, biodegradable printing inks.
- Utilise components that minimise environmental impact in compliance with European ROHS regulations (Restriction of Hazardous Substances).
- Ensure power tools are reused or recycled in compliance with WEEE regulations (Waste Electrical & Electronic Equipment).

[www.pure-diy.com](http://www.pure-diy.com)



FULLY CHARGED IN ONE HOUR



ECO-FRIENDLY, RECYCLABLE TOOLS



DOUBLE THE POWER OF NI-CAD BATTERIES



HOLDS CHARGE FOR ONE YEAR +



SUPER LIGHT-WEIGHT POWER TOOLS

PURE

10.8V



BATTERY



CHARGER



DRILL / DRIVER



JIGSAW



MULTI-TOOL



ORBITAL SANDER



PISTOL SCREWDRIVER

PURE

18V



BATTERY



CHARGER



ANGLE GRINDER



CIRCULAR SAW



DRILL / DRIVER



IMPACT DRILL



IMPACT DRIVER



JIGSAW



LED TORCH



MULTI-TOOL



PREMIUM DRILL / DRIVER

# PRIVATE LABEL MITRE SAWS

**YOUR BRAND. OUR EXPERTISE.**

Introducing our new innovative saws, designed to revitalise your range and rocket your sales!

Build your mitre saw range today!



**+ SAVE 40%**

On shipping costs with flat-pack mitre saws. See an Evolution representative for further details.



**(#1) 24V 165mm**  
Cordless Sliding Mitre Saw  
FEATURES: 3 + 6 + 7



**(#2) 190mm**  
Compound Mitre Saw  
FEATURES: 2 + 3 + 7



**(#3) 190mm**  
Sliding Mitre Saw  
FEATURES: 2 + 3 + 6 + 7 + 8



**(#4) 210mm**  
Compound Mitre Saw  
FEATURES: 2 + 3 + 7



**(#5) 210mm**  
Sliding Mitre Saw  
FEATURES: 2 + 3 + 6 + 7 + 8



**(#6) 210mm**  
Double Bevel Sliding Mitre Saw  
FEATURES: 1 + 2 + 3 + 4 + 7 + 8



**(#7) 255mm**  
Compound Mitre Saw  
FEATURES: 2 + 3 + 6 + 7



**(#8) 255mm**  
Compound Mitre Saw  
FEATURES: 1 + 2 + 3 + 4 + 7



**(#9) 255mm**  
Compound Mitre Saw  
FEATURES: 1 + 2 + 3 + 4 + 5 + 7



**(#10) 255mm**  
Sliding Mitre Saw  
FEATURES: 1 + 2 + 3 + 4 + 7 + 8



**(#11) 255mm**  
Double Bevel Sliding Mitre Saw  
FEATURES: 1 + 2 + 3 + 4 + 7 + 8



**(#12) 305mm**  
Double Bevel Compound Mitre Saw  
FEATURES: 1 + 2 + 3 + 4 + 5 + 7

## INNOVATIONS AT-A-GLANCE...

- ✓ REMOTE WORK-PIECE SUPPORT
- ✓ ERGONOMIC HANDLE
- ✓ MICRO ADJUST

- 1 SUPPORTS LONG WORK-PIECES
- 2 DUAL-HANDLE, EXERTS BETTER FORCE
- 3 0° - 45° BEVEL FUNCTION
- 4 PRECISE MICRO ADJUST END-STOPS
- 5 RAPID-RELEASE SLIDING FENCE
- 6 EXTENSIONS PROVIDE EXTRA SUPPORT
- 7 POSITIVE MITRE & BEVEL STOPS
- 8 SLIDE ACTION FOR LARGER MATERIALS



## UNITED KINGDOM

Venture 1, Longacre Close,  
Holbrook Industrial Estate,  
Sheffield, S20 3FR



## AMERICA

8363 Research Drive,  
Davenport, Iowa,  
USA, 52806



## EUROPE

61 Avenue Lafontaine,  
33560, Carbon-Blanc,  
Bordeaux, France



## JAPAN

3104 1-1-25,  
Tamatsukuri, Chuo-Ku,  
Osaka, 540-0004



## CHINA

RM 2007, Block A,  
Eton Place, 69 Dongfang Road,  
Shanghai, 200120

